

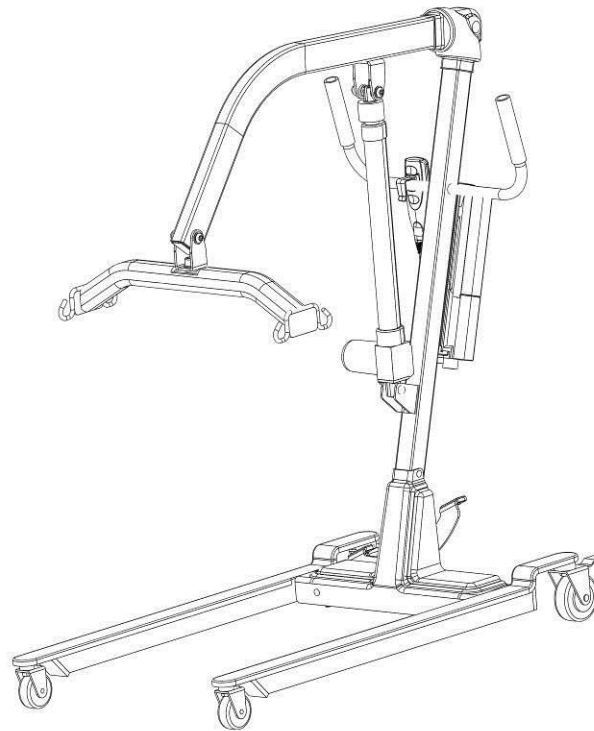

Electric Patient Lift

Model: VP235



CE
UK
CA



User Manual

BEFORE using this product, read this manual and save for future reference.

User Manual

Electric Patient Lift

1	GENERAL	4
	Symbols.....	4
	Warnings.....	4
	Warranty.....	5
2	SAFETY	6
	General Guidelines.....	6
	Operating Information.....	6
	General.....	6
	Pinch Points and Positioning.....	7
	Assembling the Lift.....	7
	Operating the Lift.....	7
	Using the Sling.....	8
	Lifting the Patient.....	9
	Transferring the Patient.....	10
	Performing Maintenance.....	10
	Electrical and Grounding.....	11
	Disposal.....	11
	Radio Frequency Interference.....	11
3	ASSEMBLY	12
	Introduction.....	12
	Patient Lift Assembly Parts.....	12
	Main Frame and Base Assembly.....	13
	Arm Lift Assembly.....	14
	Motor Assembly.....	15

	Control Box Assembly.....	16
4	OPERATION	17
	Introduction.....	17
	Remote Handset.....	17
	Electric Emergency Lowering Function.....	18
	Emergency Stop.....	18
	Base Width Adjustment.....	18
	Mechanical Emergency Lowering Function.....	19
	Caster Locking Function.....	20
	Recharging Battery and Replacement.....	20
5	LIFTING THE PATIENT	22
	Introduction.....	22
	Positioning the Patient Lift.....	22
	Attaching a Sling.....	22
	Lifting/Moving the Patient.....	23
6	TRANSFERRING THE PATIENT	24
	Introduction.....	24
	Transferring to a Commode Chair.....	25
	Transferring to a Standard Commode.....	25
	Transferring to a Bathing Unit.....	26
	Transferring to a Wheelchair.....	27
7	Technical Information	28
	Maximum A-weighted Sound Power Level.....	28
	Type and Material of Sling.....	28
	Product Life.....	28
	Method of Cleaning and Disinfection.....	28
	Mass for Detachable Parts.....	28

1 General

Symbols

Warnings

Caution words and symbols are used in this manual and apply to hazards or unsafe practices which may result in personal injury or damage. See the information below for definitions of these symbols.



DANGER

Danger indicates an impending hazardous situation which if not avoided, **will** result in death or serious injury.



WARNING

Warning indicates a potentially hazardous situation which if not avoided, **could** result in death or serious injury.



CAUTION

Caution indicates a potentially hazardous situation which if not avoided, **may** result in property damage or minor injury or both.



IMPORTANT

Indicates a hazardous situation that **could** result in damage to property if not avoided.

WARRANTY

Aidapt bathroom Ltd, Ltd. warrants to the original purchaser ("Customer") the patient lift manufactured by Aidapt to be free from defects in materials and workmanship under normal use and service. If such a defect appears and Customer has given immediate written notice of same, Aidapt shall replace or repair such part at Aidapt's option. Aidapt will require the return of the defective part to establish the claim. Aidapt's obligation under this warranty shall be limited to said replacement and/or repair. Installation and freight costs for replaced or repaired items remain the responsibility of the Customer. This warranty does not cover failure due to negligence, accident, deliberate abuse, nor improper installation and/or maintenance. Modifications made to products (including modifications without the expressed written consent of Aidapt) shall void this warranty in its entirety.

This warranty does not extend to non-durable components, such as casters, which are subject to normal wear and replacement.

NO FURTHER WARRANTIES, EXPRESSED OR IMPLIED, INCLUDING, BUT NOT LIMITED TO WARRANTIES OF MERCHANTABILITY OR FITNESS FOR A PARTICULAR PURPOSE NOT SPECIFIED HEREIN, ARE MADE BY AIDAPT AND ANY EXPRESSED OR IMPLIED WARRANTIES ARE DISCLAIMED BY AIDAPT.

Applicable warranty periods commencing from date of original purchase is one year.

2 Safety

This Safety section contains important information for the safe operation and use of this product.

2.1 General Guidelines



WARNING

DO NOT use this product without completely reading this owner's manual and any other information supplied with this product and optional accessory to this product. If you are unable to understand the warnings, cautions or instructions, contact a healthcare professional, dealer or technical personnel before attempting to use this equipment - otherwise, injury or damage may occur.



ACCESSORIES WARNING

Aidapt products are specifically designed and manufactured for use in conjunction with Aidapt. Accessories designed by other manufacturers have not been tested by Aidapt and are not recommended for use with Aidapt products.



NOTICE

THE INFORMATION CONTAINED IN THIS DOCUMENT IS SUBJECT TO CHANGE WITHOUT NOTICE.

2.2 Operating Information

General



WARNING

The Electric Patient Lift is **NOT** a transport device. It is intended to transfer an individual from one resting surface to another (such as a bed to a wheelchair). Otherwise injury or damage may occur.

DO NOT attempt any transfer without approval of the patient's physician, nurse or medical assistant.

Special care **MUST BE** taken with people with disabilities who cannot assist or cooperate while being lifted and transported.

Aidapt provide a range of slings for use with this equipment. Do not use other slings unless they are recommended for use with the lift by a competent person. Always check the sling used is suitable for the patient and a risk assessment is carried out by a competent person. Always read the relevant sling user guide provided with each sling which will explain in detail how to use the sling correctly.

Pinch Points and Positioning



WARNING

Pinch points exist between boom and spreader bar. Pinch points also exist at base of lift. When positioning lift, be aware of the position of the spreader bar and that patient injury could occur.

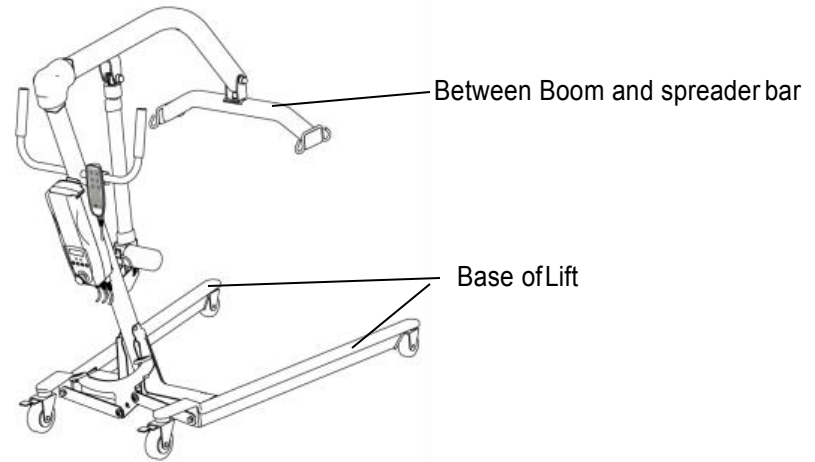

Assembling the Lift



WARNING

DO NOT overtighten mounting hardware. This will damage mounting brackets.

Operating the Lift



WARNING

Make sure you hear a click when mounting battery on the battery charger to confirm proper mounting. Otherwise, injury or damage may occur.

DO NOT exceed maximum weight limitation of the patient lift. The weight limitation for the ML-5 is 200KG.

ALWAYS keep hands and fingers clear of moving parts to avoid injury.

Please be aware of stability problems due to side forces imposed on the patient.

Using the Sling**WARNING**

Only use an approved sling that is recommended by the individual's doctor, nurse or medical assistant for the comfort and safety of the individual being lifted.

DO NOT use any kind of plastic back incontinence pad or seating cushion between patient and sling material that may cause the patient to slide out of the sling during transfer.

After each laundering (in accordance with instructions on the sling), inspect sling(s) for wear, tears, and loose stitching.

Bleached, torn, cut, frayed, or broken slings are unsafe and could result in injury. Discard immediately.

DO NOT alter slings.

Be sure to check the sling attachments each time the sling is removed and replaced, to ensure that it is properly attached before the patient is removed from an object such as a bed, wheelchair or commode.

If the patient is in a wheelchair, secure the wheel locks in place to prevent the chair from moving forwards or backwards.

When connecting slings equipped with color coded straps to the patient lift, the shortest of the straps MUST be at the back of the patient for proper support. Using the long section will leave little or no support for the patient's back. The loops of the sling are color coded and can be used to place the patient in various positions. The colors make it easy to connect both sides of the sling equally. Make sure that there is sufficient head support when lifting a patient.

A risk assessment shall be carried out to ensure that the correct size, type and shape of sling is being used for the patient.

Lifting the Patient



WARNING

When using an adjustable base lift, the legs **MUST** be in the maximum Opened/Locked position before lifting the patient.

When elevated a few inches off the surface of the stationary object (wheelchair, commode, or bed) and before moving the patient, check again to make sure that the sling is properly connected to the hooks of the spreader bar. If any attachments are not properly in place, lower the patient back onto the object such as a bed, wheelchair or commode and correct this problem.

Adjustments for safety and comfort should be made before moving the patient. Ensure the patient's arms are on the inside of the straps. Aidapt slings are made specifically for use with Aidapt Patient Lifts. For the safety of the patient, **DO NOT** intermix slings and patient lifts from other manufacturers otherwise the warranty will be voided.

During transfer, with patient suspended in a sling attached to the lift, **DO NOT** roll caster base over uneven surfaces that could cause the patient lift to tip over. Use steering handle on the mast at all times to push or pull the patient lift.

Aidapt does not recommend locking of the rear casters of the patient lift when lifting an individual. Doing so could cause the lift to tip and endanger the patient and assistants. Aidapt recommends that the rear casters be left unlocked during lifting procedures to allow the patient lift to stabilize itself when the patient is initially lifted from a chair, bed or any stationary object.

- Always maneuver the lift by using the handle provided
- Do not push the lift faster than slow walking pace
- Do not use in the shower
- Do not recharge batteries in the bathroom or shower room

Transferring the Patient



WARNING

When elevated a few inches off the surface of the object such as a bed, wheelchair or commode and before moving the patient, check again to make sure that the sling is properly connected to the hooks of the spreader bar. If any attachments are not properly in place, lower the patient back onto the object and correct this problem.

Wheelchair wheel locks **MUST** be in the locked position before lowering the patient into the wheelchair for transport.

Be sure to check the sling attachments each time the sling is removed and replaced, to ensure that it is properly attached before the patient is removed from the bed or chair.

Mast pivot under the rubber boot must be tight to ensure safe use of the patient lift. Bolt should be checked periodically to ensure patients safety and safe use of the lift.

Performing Maintenance



WARNING

Maintenance **MUST** be performed periodically and **ONLY** by qualified personnel.

The hooks of the spreader bar and the mounting brackets of the boom should be inspected periodically to determine the extent of wear. If these parts become worn, replace immediately.

Casters and axle bolts require inspections to check for tightness and wear.

Inspect the spreader bar and the eye of the boom (to which it attaches) for wear. If the metal is worn, the parts **MUST** be replaced. Regular maintenance of patient lifts and accessories is necessary to assure proper operation.

DO NOT overtighten mounting hardware. This will damage mounting brackets.

Inspect all pivot points and fasteners for wear. If the metal is worn, the parts **MUST** be replaced.

Electrical and Grounding



WARNING

GROUNDING INSTRUCTIONS

DO NOT cut or remove the round grounding prong from the plug. Some devices are equipped with three-prong (grounding) plugs for protection against possible shock hazards. Where a two-prong wall receptacle is encountered, it is the personal responsibility and obligation of the customer to contact a qualified electrician and have the two-prong receptacle replaced with a properly grounded three-prong wall receptacle in accordance with the National Electrical Code. If you must use an extension cord, use **ONLY** a three-wire extension cord having the same or higher electrical rating as the device being connected.

Carefully read battery/battery charger information prior to installing, servicing or operating the Aidapt patient lift.

Disposal

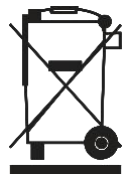

WARNING

DO NOT dispose of batteries in normal household waste. Device contains li-ion batteries. They **MUST** be taken to a proper disposal site. Contact your local waste management company for information.

This product may contain substances that could be harmful to the environment if disposed of in places (landfills) that are not appropriate according to legislation.

Please be environmentally responsible and recycle this product through your recycling facility at its end of life.

2.3 Radio Frequency Interference



WARNING

Most electronic equipment is influenced by Radio Frequency Interference (RFI). **CAUTION** should be exercised with regard to the use of portable communication equipment in the area around such equipment. If RFI causes erratic behavior, **PUSH** the Red Power Switch **OFF** **IMMEDIATELY**. **DO NOT** turn the Power Switch **ON** while transmission is in progress.

3 Assembly

3.1 Introduction



WARNING

Use only Aidapt parts in the assembly of this patient lift. The base legs, mast, boom assembly and the spreader bar are manufactured to specifications that assure correct alignment of all parts for safe functional operation.

3.2 Patient Lift Assembly Parts - listed as per the images below

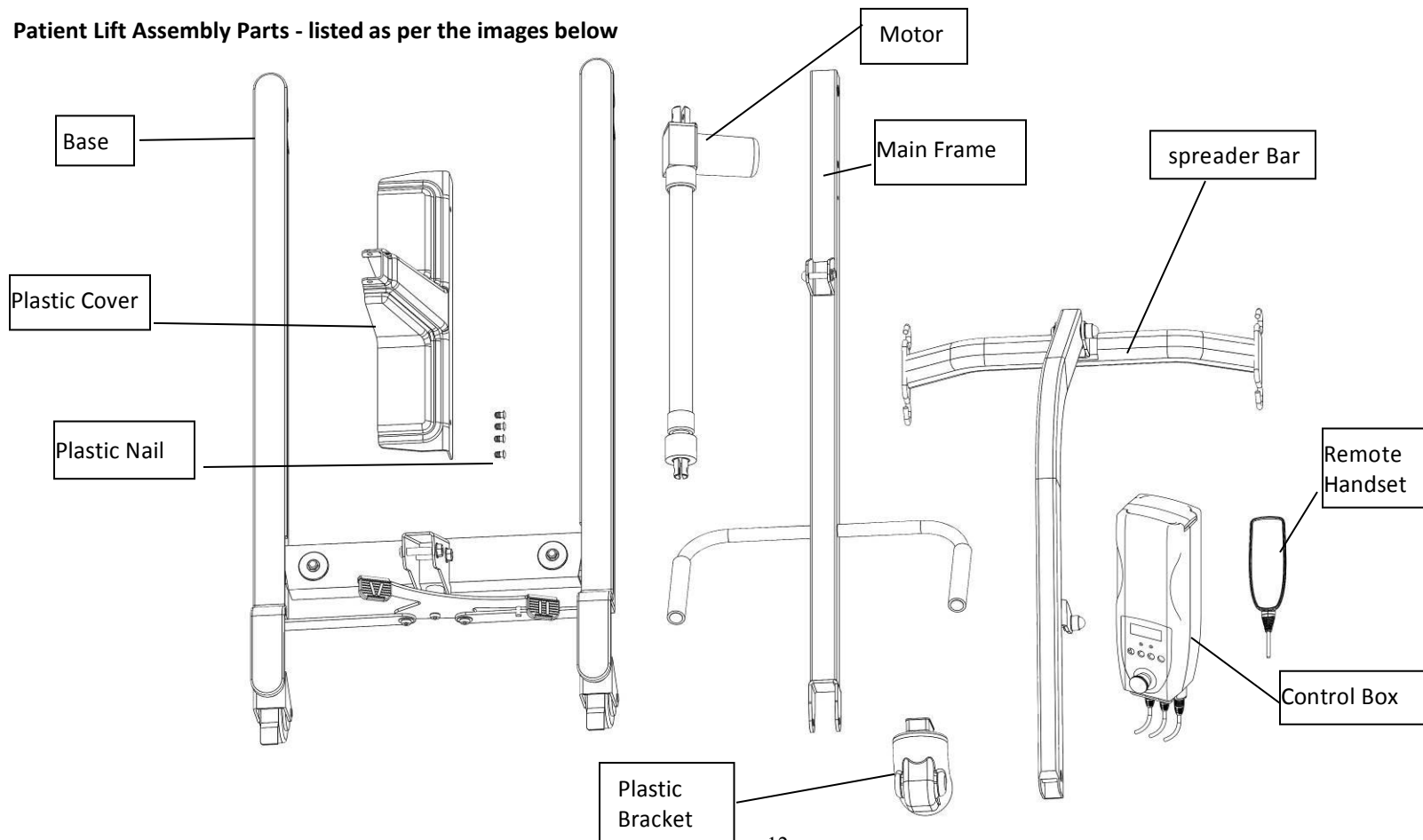

3.3 Main Frame and the Base Assembly

Hold the main frame straight and insert into the base part installation slot. Match the bolt hole, fasten the bolts and nuts with washer. Lastly attach the plastic cover with plastic nails as per the illustration below.

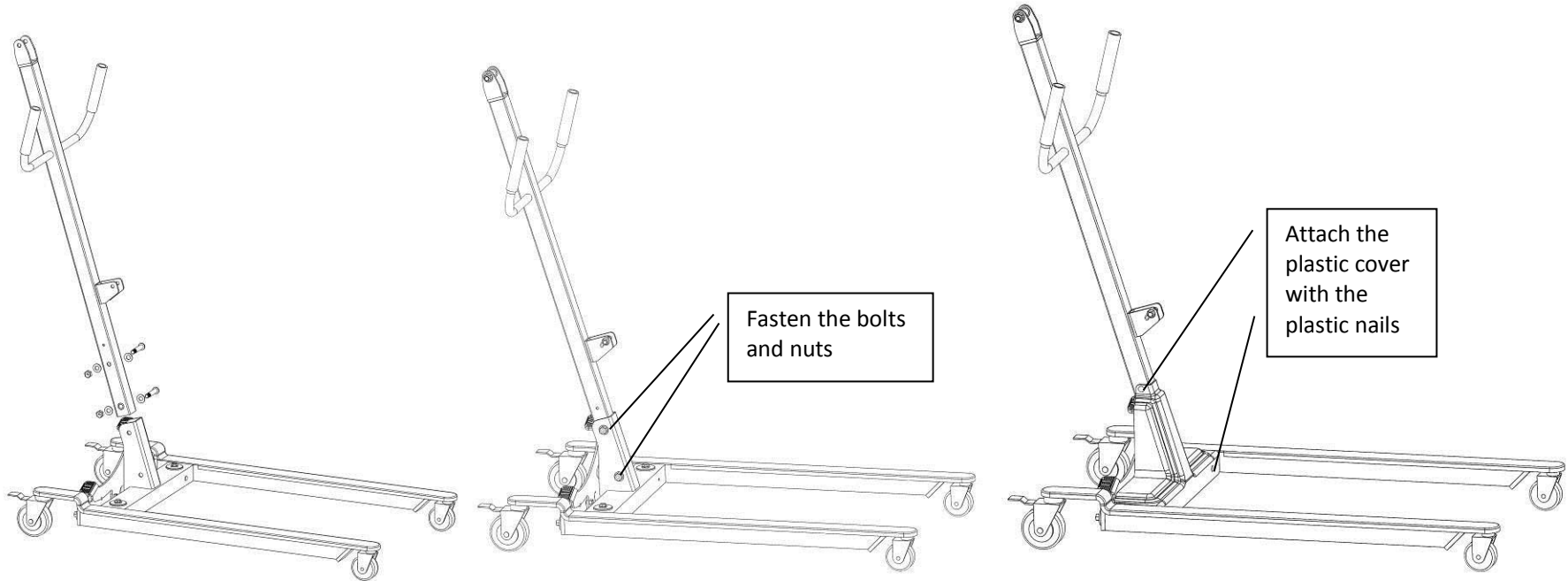

3.4 Arm Lift Assembly

Match the arm lift bolt hole with the main frame, adding the washer. Then fasten the bolt and nuts as per the illustration below.

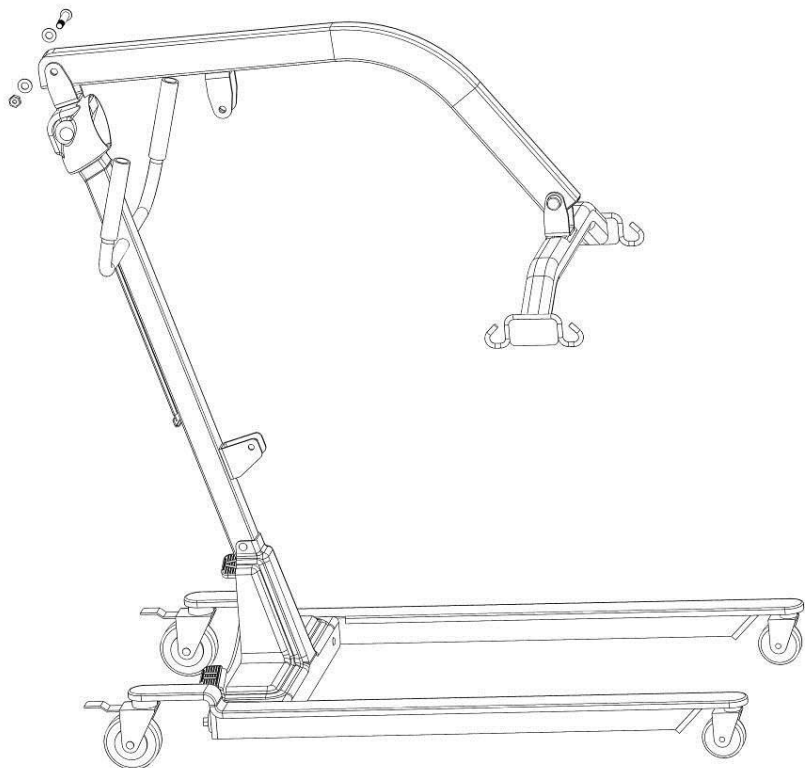

3.5 Motor Assembly

Install the motor with bolts and screws as per the illustration below.

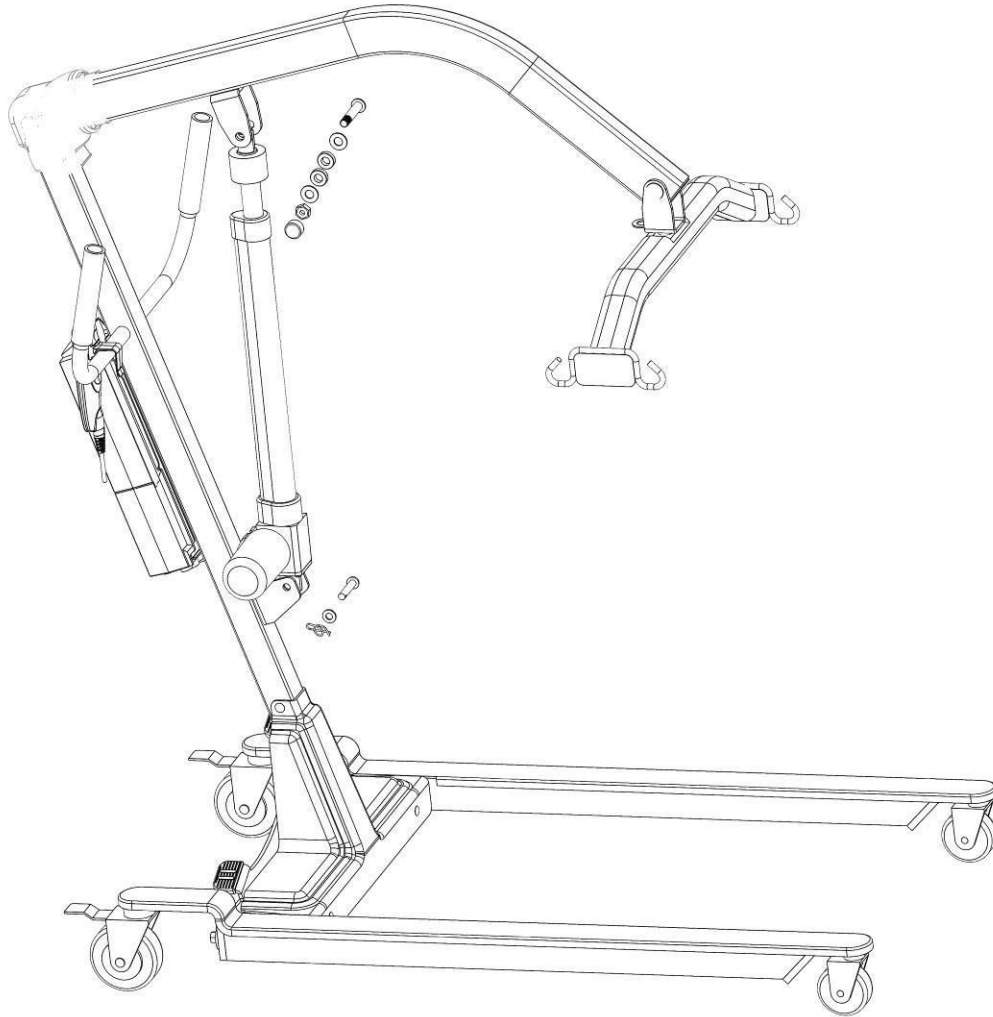

3.6 Control Box Assembly

Remove the control box cover, click the control box onto the main frame slot, then put back the cover on the control box. Connect the

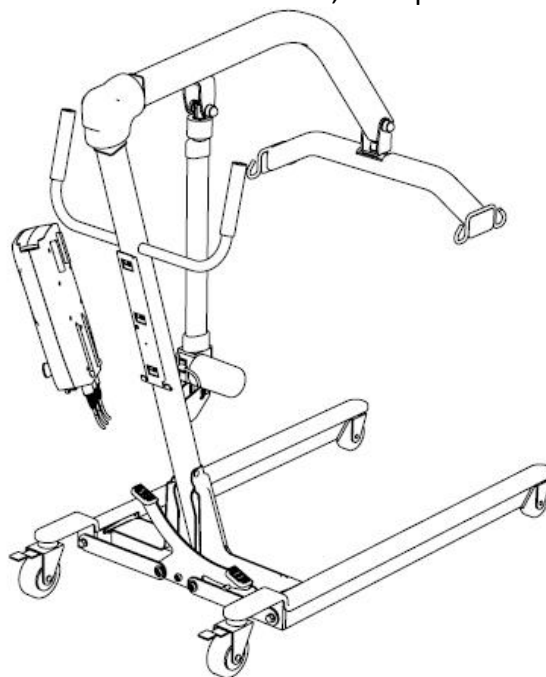

control box wire as per the illustration below.



4 Operation

4.1 Introduction



WARNING

DO NOT attempt any transfer without approval of the patient's physician, nurse or medical assistant.

The legs of the lift must be in the maximum open position for optimum stability and safety. If it is necessary to close the legs of the lift to maneuver the lift under a bed, close the legs of the lift only as long as it takes to position the lift over the patient and lift the patient off the surface of the bed. When the legs of the lift are no longer under the bed, return the legs of the lift to the maximum open position.

Aidapt recommends that two assistants be used for all lifting preparation and transferring to/from procedures. However, the patient lift can be operated with one assistant. The use of one assistant is based on the evaluation of the health care professional for each individual case.

4.2 Remote Handset

Press and hold the button to operate each function on the handset.



4.3 Control Box Operation

Press the left side up button to raise the boom. Press the right side down button to lower the boom.



4.4 Emergency Stop

Emergency Stop Function: Press the RED emergency button on the control box in, to stop the boom assembly and patient from raising or lowering.
Release/Reset: To disengage the emergency stop function, follow the arrow direction and rotate the RED emergency stop button clockwise.



4.5 Base Width Adjustment

Step on the base pedal to adjust the base width. Right pedal makes it wider, left pedal makes it narrower.

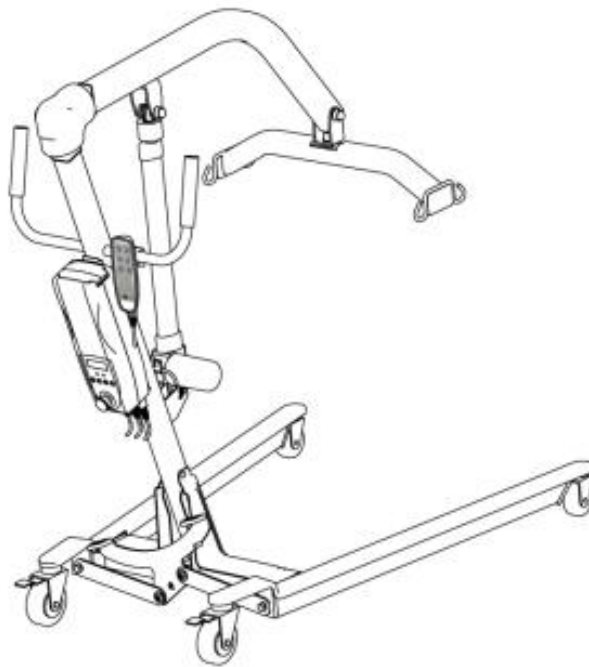
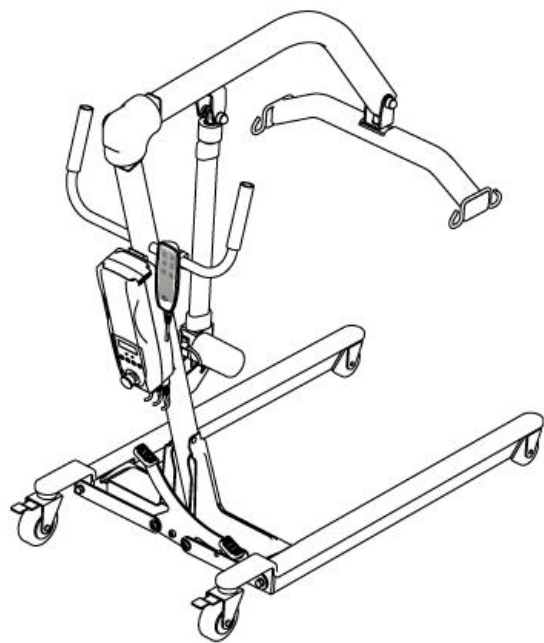

4.6 Mechanical Emergency Lowering Function

Turn the plastic red piece on the motor (as shown in the image below) in the clockwise direction to lower the arm lift. This function is used when the power in the backup battery is depleted.



4.7 Locking Caster

Lock and unlock the casters as per the illustration below.

In general, when lifting or lowering the patient, it is not necessary to lock the casters. However if the movement of the patient lift might cause an unsafe condition then it might be necessary to lock the casters.

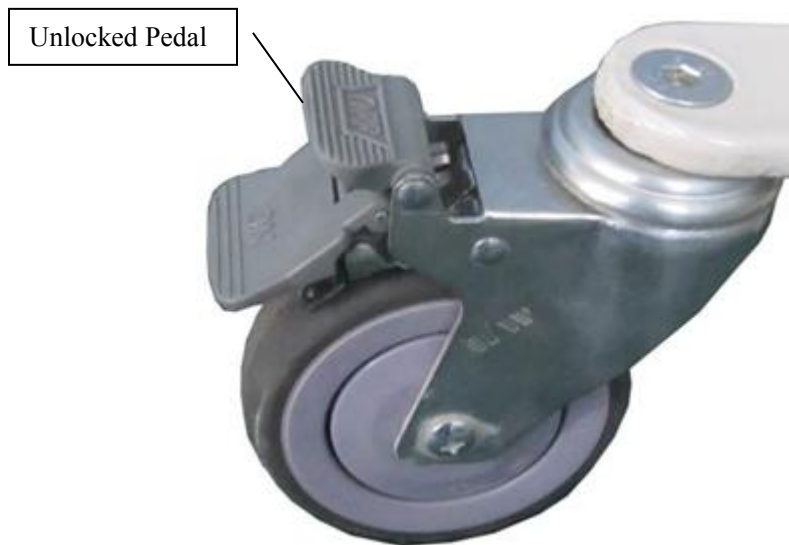

Locking Status



Unlock Status

4.8 Recharging the Battery and Replacement

When the battery level is less than 25%, the warning sound will be on. A reminder to recharging the battery. Remove the battery cover, plug in to charge as per the illustration below.

Remark: When the backup battery is not in use, place it in a dry cool area. The battery should be fully charged once a month.



Replace the battery as per the illustration below.



5 Lifting the Patient

5.1 Introduction



Aidapt recommends that two assistants be used for all lifting preparation and transferring to/from procedures; however, our equipment will permit proper operation with one assistant. Proper evaluation each individual case by a healthcare professional is required..

5.2 Positioning the Patient Lift



Refer to [Safety](#) on page 7 in this manual before proceeding further and observe all warnings indicated. Before positioning the legs of the patient lift under a bed, make sure that the area is clear of any obstructions.



WARNING

The legs of the lift must be in the maximum open position for optimum stability and safety. If it is necessary to close the legs of the lift to maneuver the lift under a bed, close the legs of the lift only as long as it takes to position the lift over the patient and lift the patient off the surface of the bed. When the legs of the lift are no longer under the bed, return the legs of the lift to the maximum open position and lock the shifter handle immediately.

1. To open the legs of the patient lift to maximum.
2. Position the patient lift using the steering handle.
3. Press the boom down button on the hand control to lower the boom for easy attachment of the sling.

5.3 Attaching a Sling

1. Place the straps of the sling over the hooks of the spreader bar.
2. Match the corresponding colors on each side of the sling for an even lift of the patient.
3. Using the lift. Refer to [Lifting/Moving the Patient](#) on page 20.

5.4 Lifting/Moving the Patient



WARNING

DO NOT lock the rear casters of the patient lift when lifting an individual. Locking the rear casters could cause the patient lift to tip and endanger the patient and assistants.

DO NOT move the patient if the sling is not properly connected to the hooks of the spreader bar. When the sling is elevated a few inches off of the stationary surface and before moving the patient, check again to make sure that the sling is properly connected to the hooks of the spreader bar. If any attachments are **NOT** properly in place, lower the patient back onto the stationary surface and correct this problem - otherwise, injury or damage may occur.

Adjustments for safety and comfort should be made before moving the patient.

When the patient is lifted from the bed (with the patient's head supported by the sling and/or an assistant), raise the patient to a sitting Position.

1. Press the boom UP button to raise the patient high enough to clear the bed. The patient's weight will be fully supported by the patient lift. The boom will stay in position until the boom DOWN (⏴) button is pressed.
2. Place patient's arms inside of sling.
3. Swing the patient's feet off the bed when the patient is clear of the bed surface.
4. Move the patient lift away from the bed using the steering handle.
5. When moving the patient lift away from the bed turn the patient so that the patient faces the assistant operating the patient lift.
6. Press the boom DOWN (⏴) button to lower the patient until the patient's legs straddle the mast and his feet rest on the base of the patient lift. The lower center of gravity provides stability making the patient feel more secure and the lift easier to move.
7. Pull the patient lift away from the bed and then push it from behind with both hands firmly on the steering handle.

6 Transferring the Patient

6.1 Introduction



WARNING

DO NOT attempt any transfer of a patient without approval of the patient's physician, nurse, or medical assistant.

DO NOT move the patient if the sling is not properly connected to the hooks of the spreader bar. When the sling is a few inches off the stationary surface and before moving the patient, check to make sure that the sling is properly connected to the hooks of the spreader bar. If any attachments are NOT properly in place, lower the patient back onto the stationary surface and correct this problem - otherwise, injury or damage may occur.

Adjustments for safety and comfort should be made before moving the patient. The patient's arms should be inside the straps.

DO NOT lock the rear casters of the patient lift when lifting an individual. Locking the rear casters could cause the patient lift to tip and endanger the patient and assistants.

The legs of the patient lift must be in the maximum open position for optimum stability and safety. If it is necessary to close the legs to maneuver the patient lift under a bed, close the legs only as long as it takes to position the patient lift over the patient and lift the patient off the surface of the bed. When the legs of the patient lift are no longer under the bed, return the legs to the maximum open position.

Be sure to check the sling attachments each time the sling is removed and replaced to ensure that it is properly attached before the patient is removed from a bed or chair.

6.2 Transferring to a Commode Chair

1. Lift the patient from the bed. Refer to Lifting the Patient on page 20.
2. Press the boom up button to elevate the patient high enough to clear the arms of the commode chair. Their weight will be supported by the patient lift.
3. Guide the patient onto the commode chair. This may require two assistants.
4. Press the boom down button to lower the patient onto the commode chair leaving the sling attached to the spreader bar hooks.
5. When complete, recheck the sling for correct attachments.
6. Press the boom up button to raise the patient off the commode chair.
7. When the patient is clear of the commode surface (using the steering handles), move the patient lift away from the commode chair.
8. To return the patient to bed, reverse the steps in Lifting the Patient on page 20.
9. To return or place the patient in a wheelchair, refer to Transferring to a Wheelchair on page 26

6.3 Transferring to a Standard Commode

The Aidapt patient lift is NOT intended as a transport device. If the bathroom facilities are NOT near the bed or if the patient lift cannot be easily maneuvered towards the commode, then it is recommended that the patient is transferred to a wheelchair/mobile chair and transported to the bathroom facilities before using the patient lift again to position the patient on a standard commode. Refer to Transferring to a Wheelchair on page 26.

1. Use an empty patient lift to check if the patient lift can maneuver around the commode.
2. If the patient lift can maneuver around the commode, lift the patient from the bed. Refer to Lifting the Patient on page 20.
3. Transport the patient to the bathroom facility.
4. Press the boom up/down buttons to elevate the patient high enough to clear the commode. Their weight will be supported by the patient lift.
5. Guide the patient onto the commode. This may require two assistants.
6. Press the boom down button to lower the patient onto the standard commode leaving the sling attached to the spreader bar hooks.
7. When complete, recheck the sling for correct attachments.
8. Press the boom up button to raise the patient off the commode.
9. When patient is clear of the commode surface (using the steering handle), move the lift away from the commode.
10. To return the patient to bed, reverse the steps in Lifting the Patient on page 20.
11. To return or place patient in a wheelchair, refer to Transferring to a Wheelchair on page 26.

6.4 Transferring to a Bathing Unit

There are many portable bathing units; this is an example of one. Refer to your particular portable bath instructions and use them in conjunction with this Owner's Manual.

1. Lift the patient from the bed. Refer to Lifting the Patient on page 20.
2. Press the boom up/down buttons to elevate the patient high enough to clear the bed and portable bath tub.
3. Slide the portable bath tub under the patient.
4. Press the boom down button to lower the patient into the portable bath tub.
5. Detach the sling from the spreader bar hooks.
6. Attach the portable bath tub straps to the patient lift.
7. Press the boom up button to raise the sides of the portable bath tub.
8. Bathe the patient.
9. Reverse this procedure to return the patient to bed.

6.5 Transferring to a Wheelchair

1. Lift the patient from the bed. Refer to Lifting the Patient on page 20.
2. Ensure the legs of the lift with patient in the sling are in the maximum open position.
3. Move the wheelchair into position.
4. Engage the rear wheel locks of the wheelchair to prevent movement of the chair.



WARNING

DO NOT place the patient in the wheelchair if the locks are not engaged. The wheelchair wheel locks MUST be in a locked position before lowering the patient into the wheelchair for transport. Otherwise, injury may result.

5. Use the straps or handles on the side and the back of the sling to guide the patient's hips as far back as possible into the seat for proper positioning.
6. Position the patient over the seat with their back against the back of the chair.
7. Begin to lower the patient either by opening the control valve or by pressing the boom down button.
8. Two assistants are recommended for this step - One assistant stands behind the chair and the other operates the patient lift. The assistant behind the chair pulls back on the grab handle or sides of the sling to seat the patient well into the back of the chair.

This will maintain a good center of balance and prevent the chair from tipping forward.

9. Leave the sling in place unless a divided leg sling was used. Remove a divided leg sling.
10. Reverse Lifting the Patient on page 20 to return to the seating surface of the wheelchair.

7 Technical Information

7.1 During a transfer using the maximum load, the maximum A-weighted sound power level of the lift is 55.9 dBA. While in an unloaded situation, it is 54.7 dBA.

7.2 The 4-connection-point sling made of polyester fiber is used in combination with the 4-point spread bar.

7.3 Product life:

Under normal use, the electric patient lift can be adjusted up & down more than 10,000 times with the maximum load.

7.4 Method of cleaning and disinfection:

The electric patient lift can be washed with neutral soapy water, or cleaner.

Under normal circumstances, the user only needs to clean the lift surface daily. Most of the micro-organisms can be removed by wiping the surface once a day with a clean wet cloth. When the lift surface is contaminated by pathogens, it must be strictly sterilized by wiping with 250mg/l-500mg/l chlorine disinfectant.

7.5 Total mass of the unloaded lift: 40KG

Base: 19.2KG

Main frame: 6.2KG

Spread bar: 8.2KG

Motor: 3.6KG

Remote handset and control box: 2KG

7.6 Operating forces of controls:

The operating forces required for the keys of handset is 3.0N, for the emergency stop is 15.0N.

7.7 List of replaceable spare parts available on request: castor, remote handset, control box, motor.

7.8 The combination of electric patient lift and separated AC adaptor is considered as ME system, the AC adaptor is not considered as part of ME equipment in this ME system, which is for charging only. The IP degree of the AC adaptor enclosure is IP20.

7.9 Drawing for key dimension

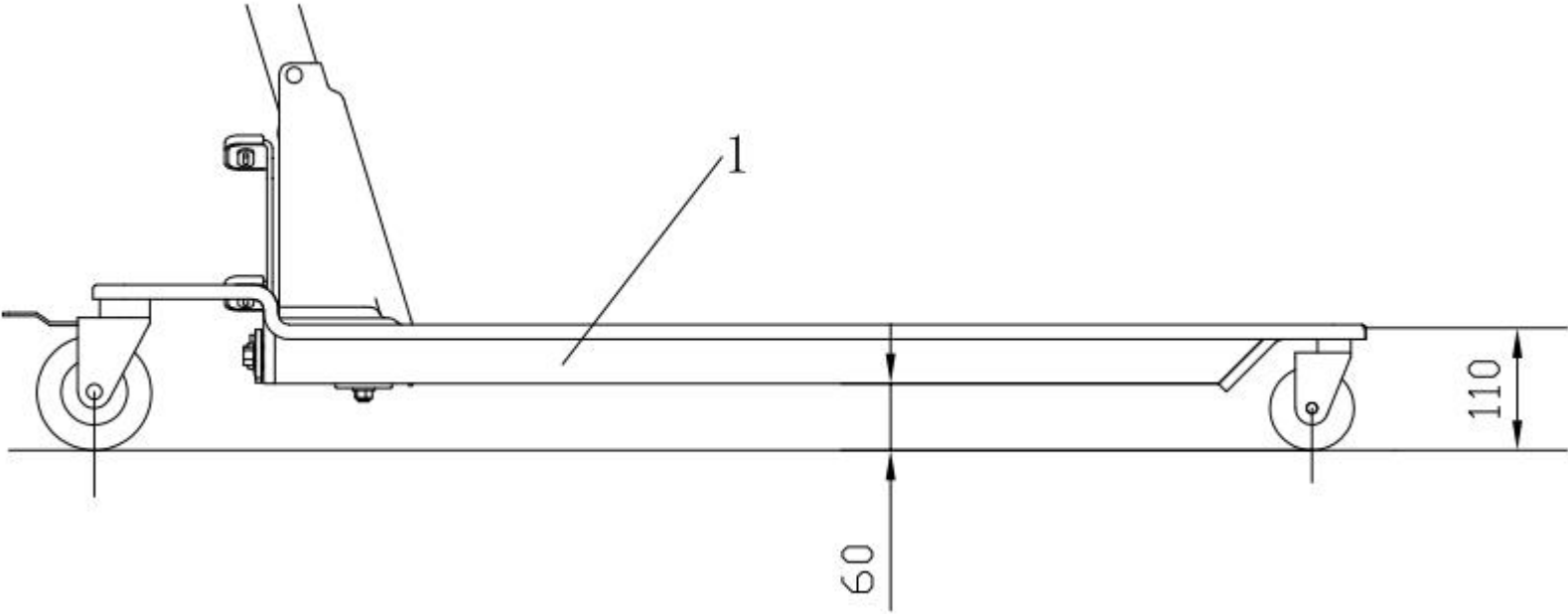

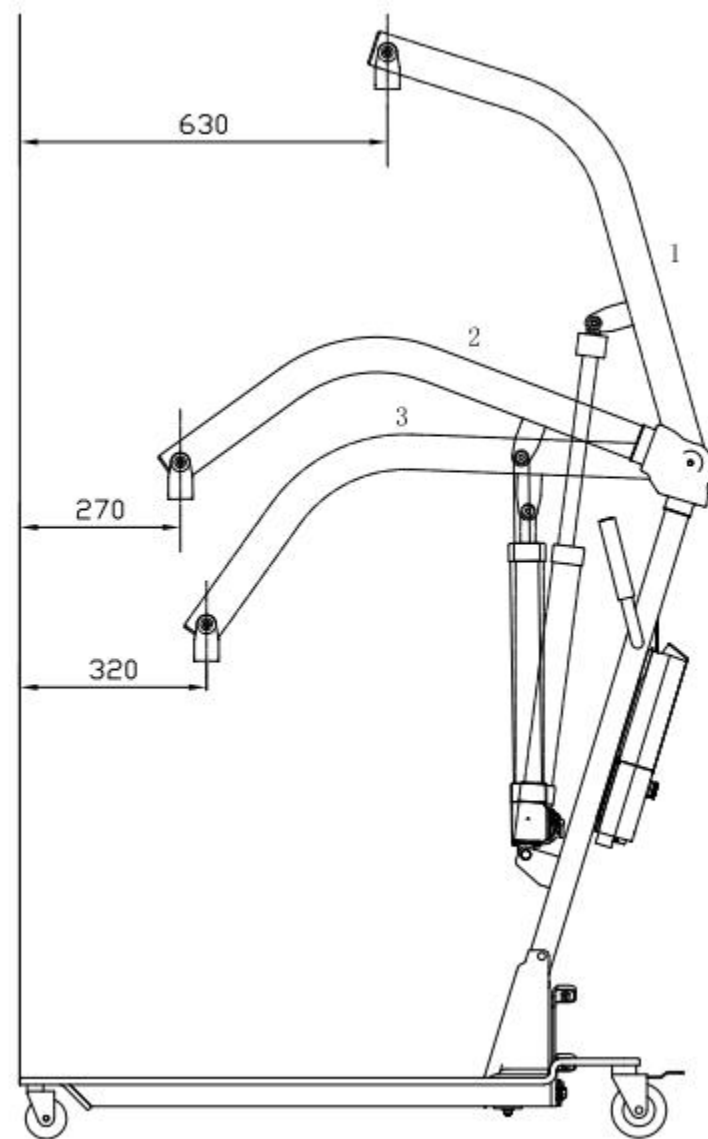
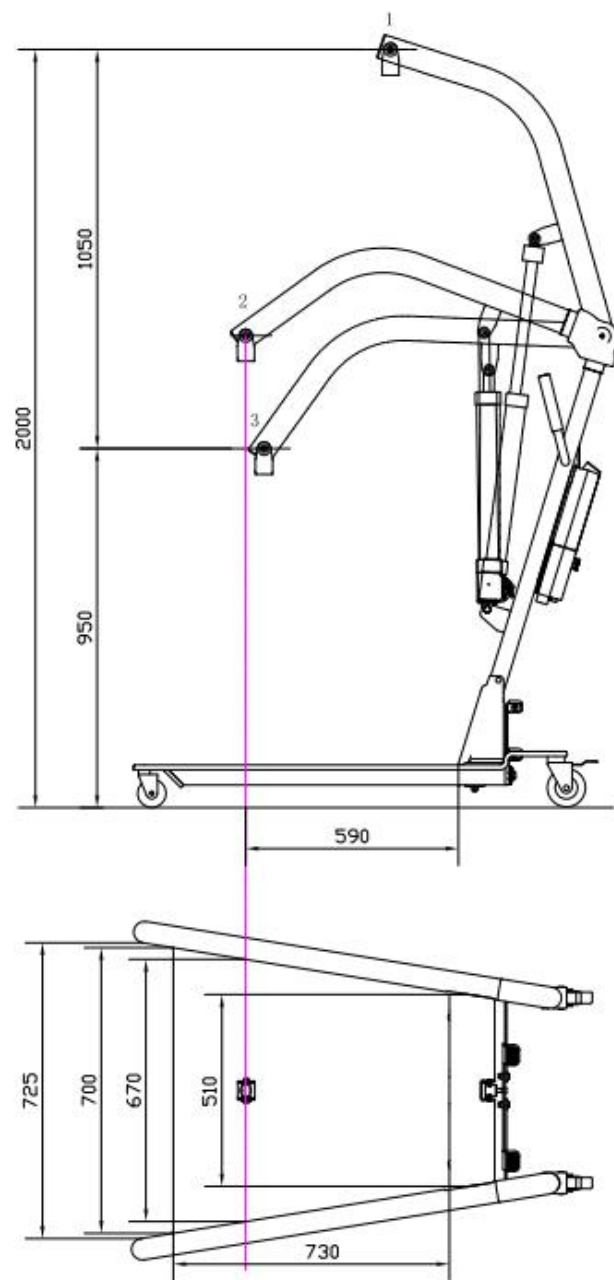

7.10 Check list before use

Check to ensure the welding parts weld firmly.

Check to ensure the screws connect firmly.

Check to ensure the mechanical parts for proper and flexible operation.

Check to ensure the normal operation of the motor.

Check to ensure the emergency stop and hand control work properly.

Check the electrical power cords for damage, crack, and entanglement.

Check to ensure the sling is properly connected to the hooks of the spreader bar.

After each laundering, inspect sling for wear, tears, and loose stitching.

Check the sling attachments each time the sling is removed and replaced, to ensure that it is properly attached before the patient is removed from an object such as a bed, wheelchair or commode.

Insert the plugs and verify they are firmly held.

Routinely check the electrical power cords for proper grounding.

7.11 Trouble shooting:

SYMPTOM	POSSIBLE CAUSE	ACTION (See steps for isolating problems)
No Power	Power Unit is not connected to A/C power.	Check plug to receptacle.
	Cut/damaged/pinched power cord.	Check Power Cord for damage.
	Loose plug for hand control.	Check hand control connection to control box.
	Cut/damaged/pinched hand control cord.	Inspect hand control cord for damage.
	Actuator plug not connected.	Check actuator connection to control box. Inspect actuator cord for damage.

8 Distributor Information

Aidapt Bathrooms Ltd.
Lancots Lane, Sutton Oak St
Helens
Merseyside
United Kingdom
WA9 3EX
Tel: 01744 745045
www.aidapt.co.uk Contact:
sales@aidapt.co.uk

UK Responsible Person

SUNGO Certification Company Limited
3rd floor
70 Gracechurch Street
London
EC3V 0HR
United Kingdom

EC	REP
----	-----

SUNGO Cert GmbH
Harffstr. 47
40591
Dusseldorf
Germany